

Technical Specifications	Standard
Motor	Dunker DC Brush Motor
Control System	Microprocessor
Adjustable Functions	15 Function
Capacity (kg)	120 kg
Manual Operating Force (Without energy)	2.5 - 4 kg
Operation Frequency	Continuous Opening-Closing
Transmission	Cog Belt
Gear Material	Powder Metallurgy
Pulley System	Adjustable 3 Wheel Pulley
Operation Voltage and Energy	AC 220 V 50/60 Hz 1.9 A - 0.8 A 120 W
Speed	150 - 650 mm/sec (Adjustable)
Applicable Door Dimension (mm)	Applicable acc.to the door dimension
Optimum Distance	600 - 5000 mm (1 Wing)
Keep Opening Time	1-60 sec
Ambient Temperature	-20 ° C - +45 ° C

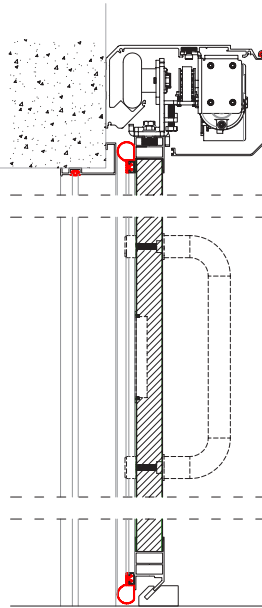

“METAXDOOR HM30/HRM Hermetic sliding door that has air and water impermeability is the best choice for hygienic areas.”



Plan Details

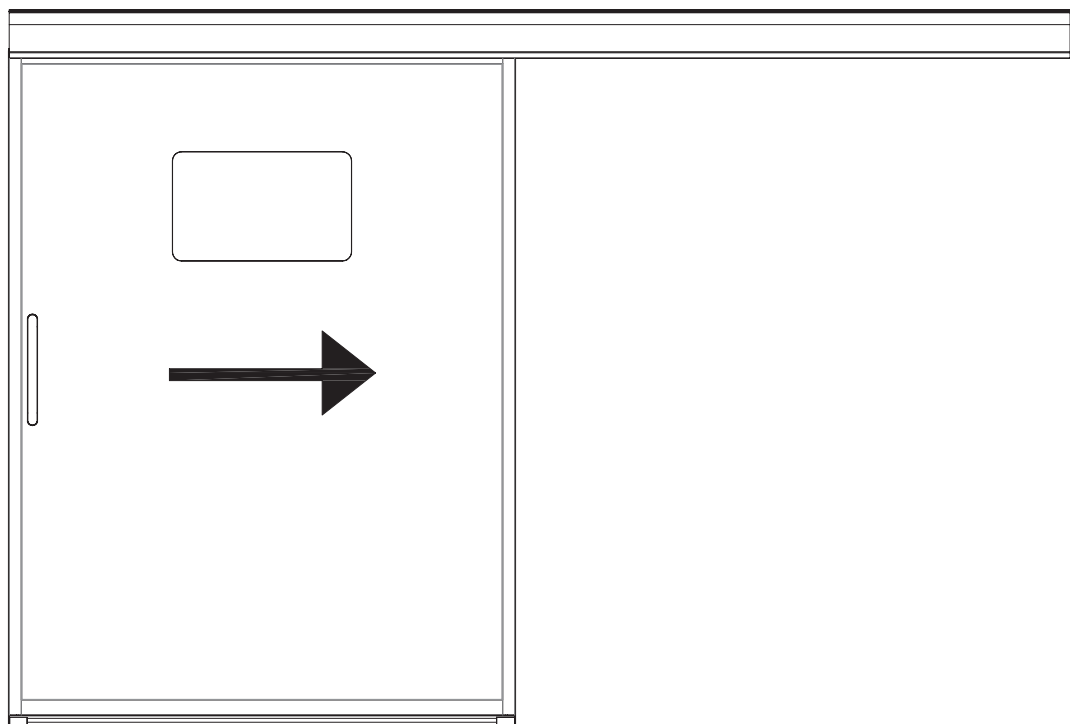
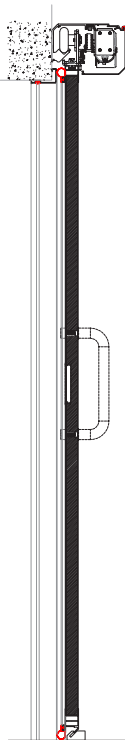

For hospital and clinic rooms high quality hygienic is very important. HM30/HRM is the system that is manufactured as air and water sealed door by METAXDOOR. This door is manufactured as a modular system and it can be adapted according to customers' requirements.

METAXDOOR HM30/HRM is used for places that is required high quality hygiene like operating rooms, medical rooms, research laboratories, quarantine rooms.